

GRAND CENTRAL HOTEL

Glasgow

	Theatre	Cabaret	Classroom	Boardroom	'U' shape	Dinner	Dinner dance	Wedding	Reception	Length (m)	Width (m)	Ceiling height (m)
Grand Room	400	248	336	-	-	400	360	360	600	31.44	13.73	8.3
Victorian	300	160	200	-	-	240	200	200	300	20	11.3	2.55
Regent	100	72	84	48	50	100	80	100	180	17	13.44	3.75
Buchanan	36	32	24	24	24	40	-	40	40	15.5	8.53	3.65
Great Western	50	30	24	30	24	50	-	50	50	8.96	5.41	3.98
Wellington	50	30	24	30	24	50	-	50	50	10.7	5.41	3.89
Campbell	12	-	12	12	10	12	-	-	-	10.69	4.95	4.88
Carnegie	12	-	12	12	10	12	-	-	-	5.4	5.08	4.6
Chamberlain	18	-	10	12	10	12	-	-	-	5.4	5.05	4.6
Drummond	18	-	8	10	-	10	-	-	-	5.4	4.88	4.6
Hamilton	18	-	12	12	10	12	-	-	-	5.4	4.88	4.6
Mandela	12	-	10	12	10	12	-	-	-	5.4	5.26	3.19
Melville	12	-	10	12	10	12	-	-	-	5.4	5.29	4.9
Bells	18	-	-	12	-	12	-	-	-	5.4	5.18	2.94
Caledonian	18	-	10	12	10	12	-	-	-	5.38	6.12	3.3
Erskine	20	-	-	10	10	10	-	-	-	5.08	5.4	4.6
Kingston	18	-	-	12	10	12	-	-	-	4.5	4.46	3.3
St Andrews	20	-	18	14	-	14	-	-	-	5.4	5.18	2.94
Clyde	80	56	30	50	40	80	60	80	10	15.54	5.67	3.82
Queens	40	-	-	-	25	40	-	40	60	10.56	5.4	4.9
Queen Mary	20	-	-	-	1	20	-	20	30	5.28	5.4	4.9
Queen Elizabeth	20	-	-	-	-	20	-	20	30	5.28	5.4	4.9

Floor plans

First floor

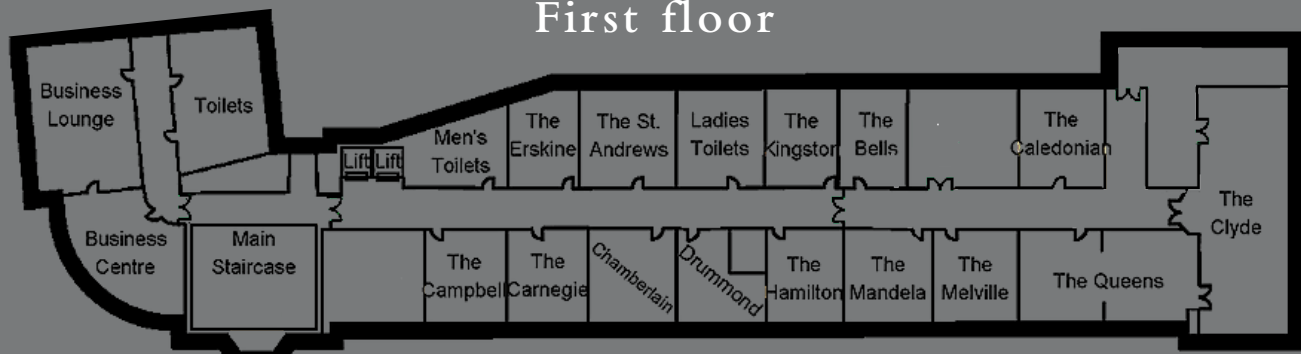

Entresol

